



Serpentine Road, Aston
Birmingham, B6 6SA

Guide Price £120,000

Aston

Guide Price £120,000

2  2  2 

Paul Carr Estate Agents are pleased to offer this two bedroom mid terrace family home which has NO CHAIN.

Located on a popular and sought after residential road in Aston the property comprises; two reception rooms, kitchen and shower room to the ground floor.

The first floor consists of two double bedrooms, with bathroom leading off the second bedroom.

Low maintenance garden to the rear. Ideally located for local amenities, public transport links and School catchment area.





Property Specification

OFFERED WITH NO UPWARD CHAIN
CONVENIENT FOR BIRMINGHAM CITY CENTRE
THE PROPERTY BRIEFLY COMPRISES;

Reception Room 3.50m (11'6") x 3.45m (11'4")

Reception Room 4.48m (14'9") x 3.50m (11'6")

Kitchen 2.82m (9'3") x 1.96m (6'5")

Shower Room 2.04m (6'8") x 1.96m (6'5")

Bedroom 1 3.49m (11'5") x 3.49m (11'5")

Bedroom 2 3.53m (11'7") x 3.50m (11'6")

Bathroom

Agent's Note:

Every care has been taken with the preparation of these Sales Particulars but they are for general guidance only and complete accuracy cannot be guaranteed. If there is any point which is of particular importance, professional verification should be sought. The mention of any fixtures, fittings and/or appliances does not imply they are in full efficient working order as they have not been tested. All dimensions are approximate. Photographs are reproduced for general information and it cannot be inferred that any item shown is included in the sale. These Sales Particulars do not constitute a contract or part of a contract.
Came on the market: 11th September 2023

Viewer's Note:

Services connected: Gas, electric, water and drainage
Council tax band: A
Tenure: Freehold

Floor Plan

This floor plan is not drawn to scale and is for illustration purposes only

Ground Floor
Approx. 38.1 sq. metres (409.9 sq. feet)

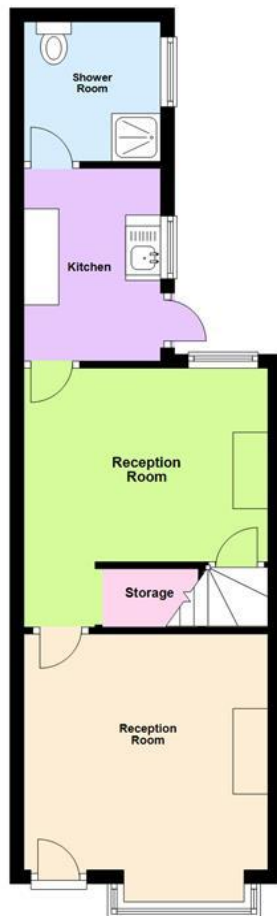

First Floor
Approx. 33.6 sq. metres (362.2 sq. feet)



Total area: approx. 71.7 sq. metres (772.1 sq. feet)

Energy Efficiency Rating

| Score | Energy rating | Current | Potential |
|-------|---------------|---------|-----------|
| 92+ | A | | |
| 81-91 | B | | 81 B |
| 69-80 | C | | |
| 55-68 | D | | |
| 39-54 | E | | |
| 21-38 | F | 36 F | |
| 1-20 | G | | |

Map Location

